



‘Antwerpen Zie
je OP ‘t
16^{de}’



CROWNE PLAZA®
ANTWERPEN

Unbeatable location

- Central location in the Benelux, easy to reach from anywhere
- International accessibility:
 - Brussels Airport within 25 minutes drive
 - Antwerp Airport within 10 minutes drive, direct flights to/from London & Manchester
 - Antwerp Central railway station for high speed train Thalys
 - Amsterdam within 2 hours drive
 - Paris within 3 hours drive
- Local accessibility:
 - City center of Antwerp at 2 km from the hotel:
 - Shopping, fashion, gastronomy and diamonds
 - Ring road location and next to Antwerp Expo

Easy parking

- Hotel parking for 170 cars
- 700 Spaces in the direct vicinity

Shuttle service & public transportation

- Shuttle service from/to Brussels Airport at approx. € 10,00 one way
- Shuttle service from/to Charleroi Airport (Brussels South) as from € 25,00 one way
- City bikes for rent at the hotel
- Easy access with public transportation



Meeting in't Stad

16th Floor: 'Antwerpen zie je op't 16de'

An amazing panoramic view of Antwerp from 61m above the River Scheldt. See Antwerp from another perspective and bring your meeting to the top!

- 7 Meeting rooms for 10 to 80 delegates & 2 SkyLounges in boardroom style for 9 delegates each

Ground floor: 'The Docks of Antwerp'

the centre of activity, perseverance, involvement, teamwork and 'down-to-earth' meetings

- 5 multifunctional meeting rooms up to 500 delegates
- Sophisticated lighting system with mood light options
- 250m² exhibition space

[Babbel] 1&2:

- Meeting room in boardroom style for a business appointment, an interview or a small meeting with more privacy
- Rental per person, per hour

Hands-on meeting services

- 2 dedicated meeting coordinators
- Welcome desk
- Signage LCD screens
- Each meeting room is equipped with LCD projector, flipchart with markers, screen
- Free WiFi
- Audiovisual, sound and translation equipment available upon request
- Pre- and post-meeting suggestions to discover and experience Antwerp

"Octopus" The Fascinating Event Pool

- Unique setting for the story you want to reveal, a swimming pool extraordinaire
- Astonishing decor for cocktails or walking dinners as from 50 up to 150 invitees
- Event space can be fully personalised
- Ideal in combination with residential meetings or stand-alone events



Fit & healthy

- Complimentary access to Pool & Wellness Centre 'Octopus' (swimming pool, fitness, sauna and steam bath)
- Jogging tracks in park Middelheim next to the hotel

262 comfortable guest rooms and suites

- With a contemporary and fresh design
- 88 standard rooms, 110 superior rooms, 62 deluxe rooms and 2 suites
- Floor-to-ceiling windows to enjoy the unique view
- Large working desk
- Individual climate control
- Flat screen TV
- In-room pay movies
- Coffee & tea making facilities
- In-room safe
- Free WiFi
- Trouser press

Antwerp's Living & Bar ANNA

- Living & Bar for business and pleasure get-togethers
- Breakfast, lunch, dinner or in-betweens







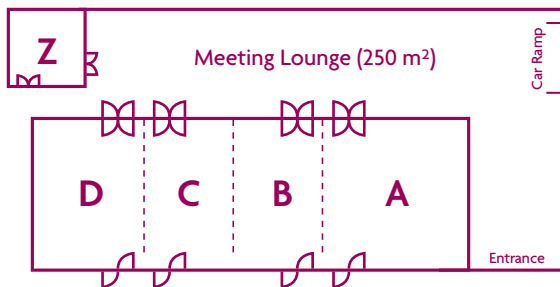

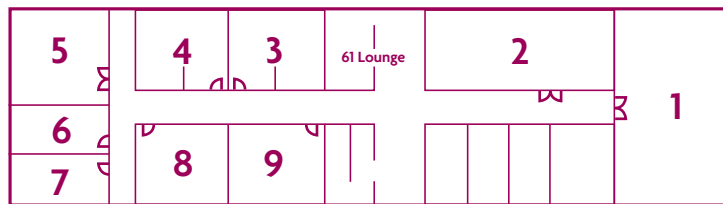

MEETING ROOM CAPACITIES

Ground Floor



16th Floor



MEETING ROOM	M ²								HEIGHT	L X W
GROUND FLOOR										
Albertdok	147	150	90	40	60	-	120	150	3,33	11,0 x 13,3
Bonapartedok	101	70	54	30	36	-	60	80	3,33	7,6 x 13,3
Churchilldok	101	70	54	30	36	-	60	80	3,33	7,6 x 13,3
Deurganckdok	117	100	60	35	42	-	80	100	3,33	8,8 x 13,3
Zuiderdok	64	50	27	21	18	-	40	50	2,73	7,4 x 8,6
ABCD	466	500	320	-	200	-	350	500	3,33	35,0 x 13,3
AB	247	250	160	60	100	-	200	250	3,33	18,6 x 13,3
ABC	348	400	230	-	140	-	250	350	3,33	26,2 x 13,3
CD	227	225	145	50	80	-	150	200	3,33	16,4 x 13,3
BCD	319	350	220	-	120	-	225	275	3,33	24,0 x 13,3
16TH FLOOR										
Meeting Room 1	104	80	54	30	36	20	60	80	2,73	14,3 x 7,3
Meeting Room 2	61	30	25	18	15	18	30	50	2,73	15 x 5,5
SkyLounge 3	47	-	-	-	-	9	-	-	2,73	6,5 x 7,2
SkyLounge 4	47	-	-	-	-	9	-	-	2,73	6,5 x 7,2
Meeting Room 5	53	25	20	15	12	15	-	-	2,73	7,5 x 6,3
Meeting Room 6	23	-	-	-	-	10	-	-	2,73	6,5 x 3,6
Meeting Room 7	23	-	-	-	-	10	-	-	2,73	6,5 x 3,6
Meeting Room 8	53	25	20	15	12	15	-	-	2,73	7,4 x 7,2
Meeting Room 9	53	25	20	15	12	15	-	-	2,73	7,4 x 7,2



CROWNE PLAZA®

ANTWERPEN

Crowne Plaza Antwerpen

Gerard Le Grellelaan 10, 2020 Antwerpen, Belgium

Tel: +32 (0)3 259 75 00 - Fax: +32 (0)3 216 02 96

meeting@cpantwerp.com - www.crowneplaza-antwerpen.be - www.octopus-eventpool.be

